

Starter Kit

BEFORE YOU BEGIN, MAKE SURE YOU CAREFULLY READ AND UNDERSTAND THE INSTRUCTIONS IN THIS MANUAL. The 8000 Series system includes an assortment of components to cover a variety of indoor or outdoor applications. Our goal is to make this installation easy for you. Please follow the instructions in the order presented in this manual and be sure to observe all warnings and cautions.



IMPORTANT: Each connector consists of two parts, a top and bottom, which are partially assembled at the factory. They are shipped with a protective piece of orange plastic that must be removed before installation. This piece prevents the connectors from accidentally being pushed together. Do not remove this piece, or push the connectors together BEFORE installation. Do not cut the LED strip before planning your installation.

Make certain the following components are included in the package. If any of the parts are missing or damaged please contact OptiLED Customer Service. Parts are not shown actual size.



unpack

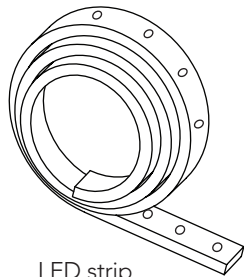

LED strip
6'6" (2M)

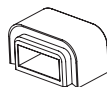

End Cap
1 piece

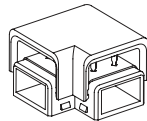

L-Connector
2 pieces

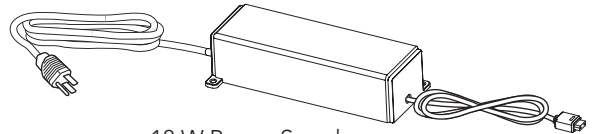

18 W Power Supply
supports up to 16'4" (5M) LED strip
1 piece

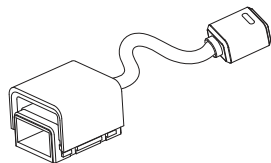

PS-Link Connector
1 piece



Channel Bracket
8 pieces



M3 x 6mm Screw
(for mounting bracket)
8 pieces



M4 x 10mm Screw
(for mounting power supply)
2 pieces



required tools

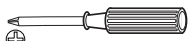

Phillips Screw Driver



Power
Drill



Pencil



Scissors



Safety Glasses

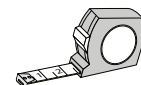



Tape Measure



Pliers

IMPORTANT WARNINGS AND CAUTIONS!

 **WARNING:** A WARNING alerts you to the possibility of serious injury or death if you do not follow the instructions.

 **CAUTION:** A CAUTION alerts you to the possibility of damage to or destruction of the equipment if you do not follow the corresponding instructions.

WARNING: Do not open, dismantle or attempt to repair the LED strip, bottom half of the connectors or power supply. There are no user serviceable parts. Products should be installed in accordance with the owner's manual, current electrical codes and/or the current National Electric Code (NEC).

Improper installation may present a possible shock or fire hazard. Always make sure the LED strip is disconnected from the power source before cutting, connecting, mounting or modifying in any way.

The LED strip is water resistant, not water proof. Do not submerge. Mount power supply at least one foot above the ground. Do not submerge in water.

Safety measures must be observed at all times during the installation of this product. Use proper safety gear and tools during the installation process to prevent physical injury.

Do not look directly at the LED lights in the CabLED strip when lit.

CAUTION: Create layout plan before installation. Locate power supply, determine suitable mounting methods and connectors, measure and calculate the length of required. LED strip can only be cut only at every 7 inches (18cm) and must be cut exactly on the indicated mark.

Use only CabLED connectors, mountings and power supply.

Do not use acid or alkaline liquid to clean.

TABLE OF CONTENTS

| | |
|--------------------------------|-----|
| Unpack | 1 |
| Required Tools | 1 |
| Warnings and Cautions | 2 |
| Plan Your Installation | 3 |
| Measure and Mark Surface | 3 |
| Mark and Cut LED Strip | 4 |
| Install Connectors | 5-6 |
| Test | 7 |
| Mount Brackets | 7 |
| Mount Power Supply | 7 |
| Install LED Strip | 7 |
| Connect to Power | 8 |
| Troubleshooting | 8 |

Step 1: Plan Your Installation



IMPORTANT: The connectors consist of two parts, a top and bottom, which are partially assembled at the factory. Do not push the connectors together or cut the LED strip **BEFORE** you have planned your installation.

We have included an assortment of components to cover a variety of indoor or outdoor applications. Plan your installation carefully to decide exactly which components your installation requires.

All installations require the PS-Link Connector, which connects the LED strip to the power supply and the End Cap which is used to protect the other end of the LED strip. Use the L-Connectors for corners.

Step 2: Measure and Mark Surface

There are a few things to consider when measuring for your installation.

- Determine where your power supply will be mounted and plan your installation so the PS-Link Connector will be near the wall outlet.
- The connectors add about 1/2 inch of length to the end of the LED strip and the LED strip may **ONLY** be cut along the cut line marked at every 7 inches on the top of the strip.
- It may be useful to lay out the strip and connectors to visualize how the components fit together in your space before you begin. **DO NOT PUSH CONNECTORS TOGETHER.**
- Measure and mark the surface where the LED strip will be installed.

IMPORTANT: The LED strip may **ONLY** be cut every 7 inches, indicated by a cut line on the LED side of the strip. When you are measuring for your installation, if the total length is not a multiple of 7, then adjust the plan of your layout to be cut on the nearest mark.

2.1 For use in a straight area

Measure and mark the surface where the LED strip will be installed.
Use the PS-Link Connector and End Cap for installation.

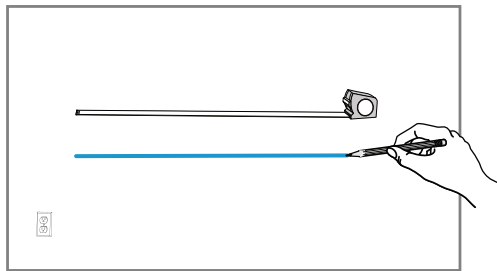

IMPORTANT: Place power supply near outlet and off the ground.

2.2 For use in a corner area

Measure and mark the surface where the LED strip will be installed.
Use the PS-Link Connector, End Cap and one L-Connector for installation.

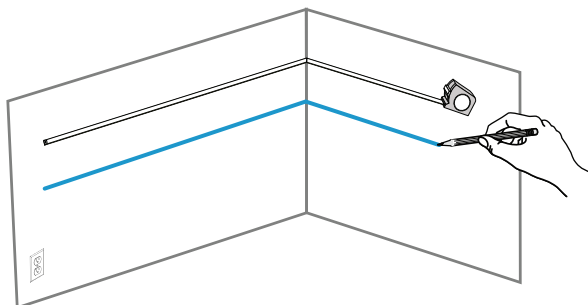

IMPORTANT: Place power supply near outlet and off the ground.

Step 3: Mark and Cut LED Strip

3.1 Mark LED strip

Hold the LED strip up to the surface you just marked, locate nearest cut line and mark.

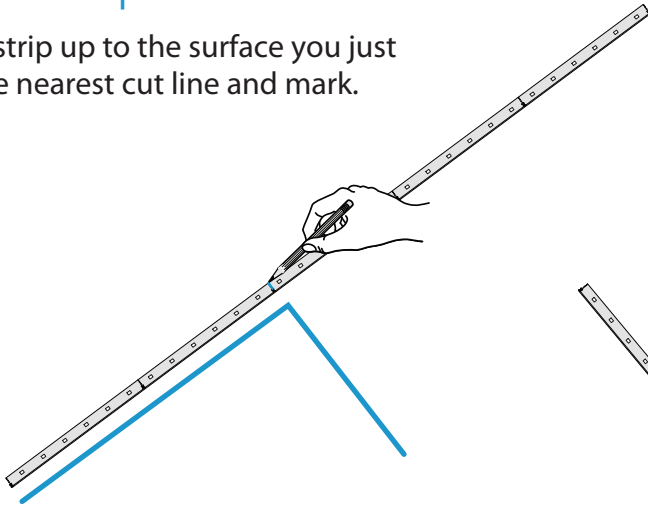

Rotate the strip along the surface you marked, locate nearest cut line and mark. Rotate and mark again for three-sided area. Adjust your layout if necessary.

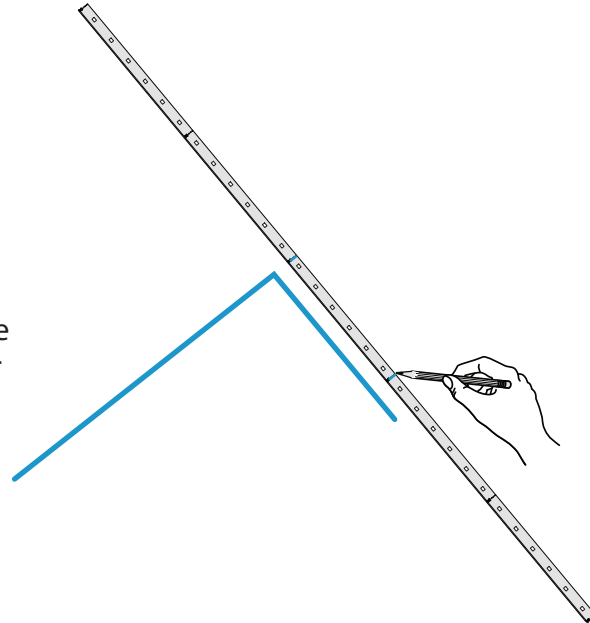

3.2 Cut LED strip

Use a pair of sharp scissors to cut the LED strip EXACTLY on the cut lines you have marked.

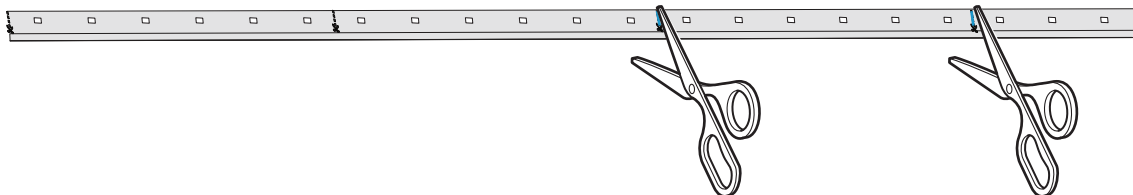

Step 4: Install Connectors

4.1 Install PS-Link Connector

4.1A Find the end of the LED strip that will be installed nearest to the power. Remove the orange protective piece from the PS-Link Connector. With LED side facing up, slide the strip into the opening in bottom half of the connector until it reaches the end.

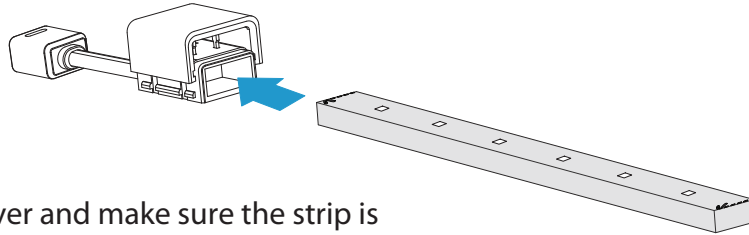

4.1B Turn the connector over and make sure the strip is pushed completely to the back of the connector.

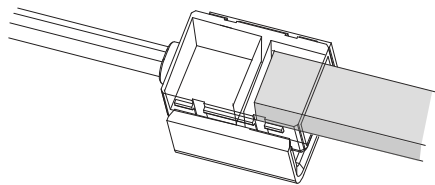

4.1C Using pliers, apply even pressure to the bottom and top halves of the connector to push connector together, securing LED strip inside.

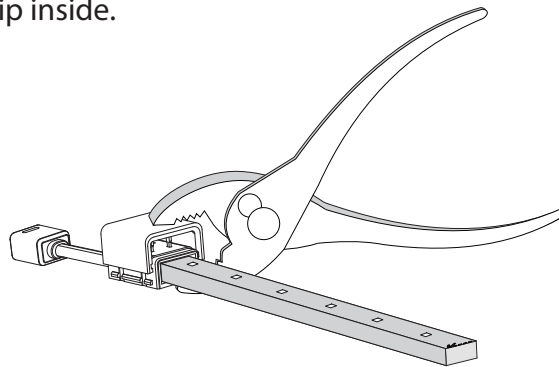

IMPORTANT: When using pliers that do not cover the surface of the connector, apply pressure to one side of the connector to push the connector together. Without moving the strip or the connector, carefully rotate the pliers to apply pressure to the other side of the connector.

4.1C Make sure both sides of the bottom half of the connector snap into the top half. Gently pull the LED strip to make sure you have installed it properly.

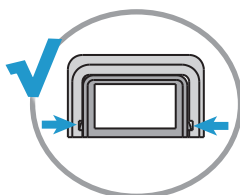

Correct

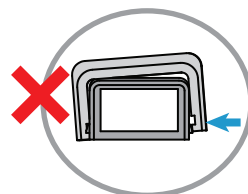

Incorrect

4.2 Install L-Connector

4.2A Remove the orange protective piece from L-Connector. With the LED side of each strip facing up, insert one strip into one side of the L-Connector and push to the end. Insert the other strip into the other side and push it to the end.

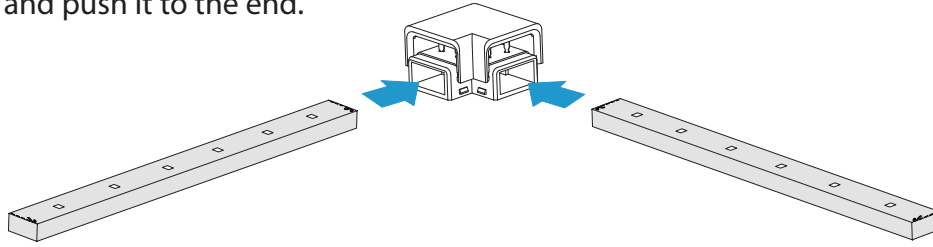

4.2B Turn the connector over and make sure both LED strips are pushed completely to the back of the connector.

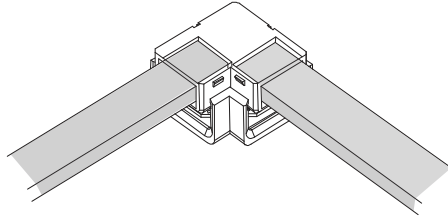

4.2C Using pliers, apply even pressure to the bottom and top connector to push connector together, securing LED strips inside.

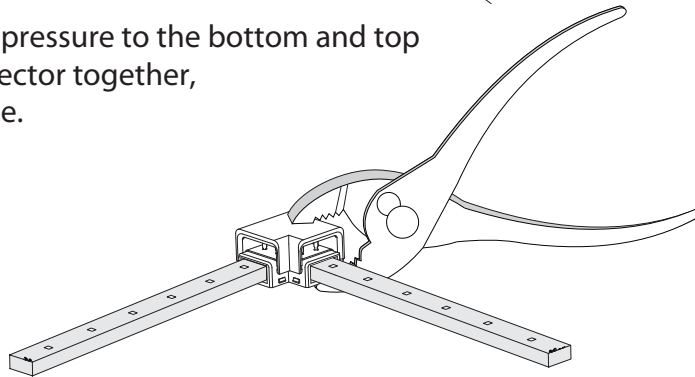

IMPORTANT: When using pliers that do not cover the surface of the connector, apply pressure to one side of the connector to push the connector together. With out moving the strip or the connector, carefully rotate the pliers to apply pressure to the other side of the connector.

4.2D Make sure both sides of the bottom half of the connector snap into the top half. Gently pull the LED strips to make sure you have installed it properly.

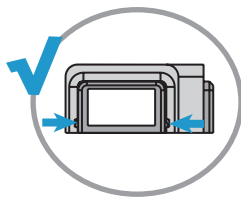

Correct

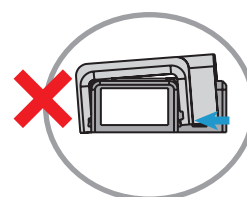

Incorrect

4.3 Install End Cap

Slide End Cap onto LED strip that will have no connector.
The End Cap protects the strip.

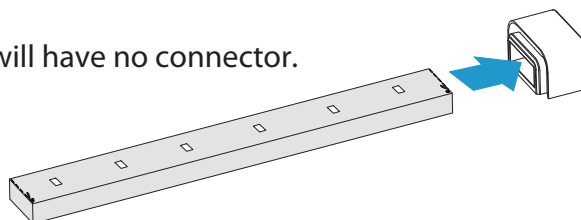

Step 5: Test

Connect the other end of the PS-Link Connector to the power supply and plug the power supply into the wall outlet to test your assembly. If it works properly, unplug and continue. If not, see the Troubleshooting section.

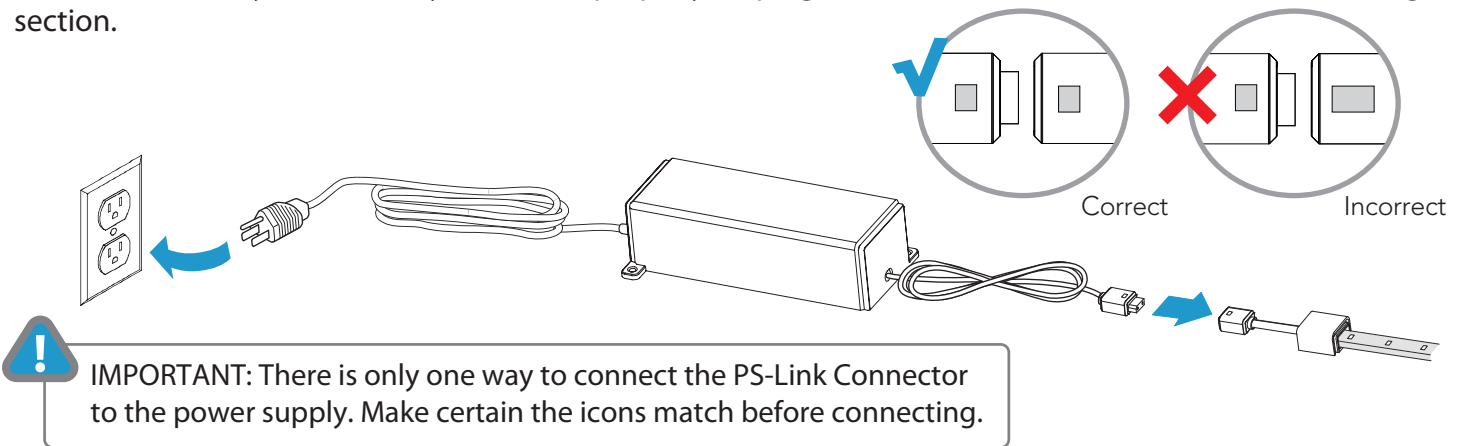

Step 6: Mount

6.1 Mount Brackets

Mark position of channel brackets on wall along your placement line. Allow a half inch to clear the PS-Link Connector and End Cap, and an inch on each side of the L-Connectors. Space evenly every 12 to 16 inches. Use a screwdriver to install

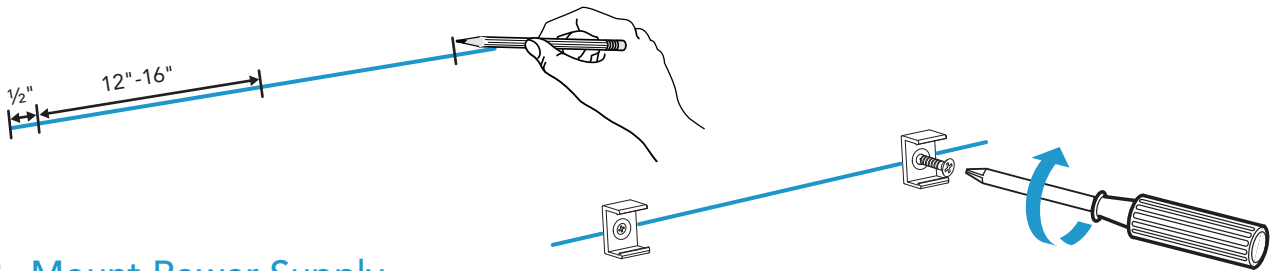

6.2 Mount Power Supply

Position power supply near power outlet and secure using two M4 screws. **IMPORTANT:** Do not plug into outlet until power supply is secured.

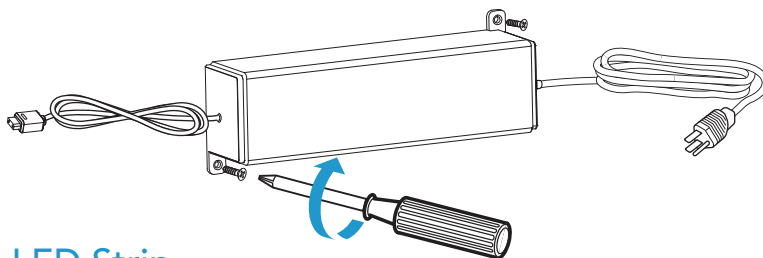

6.3 Install LED Strip

Install LED strip by pressing it firmly into each channel bracket. Working from PS-Link to End Cap, make certain strip lies flat.

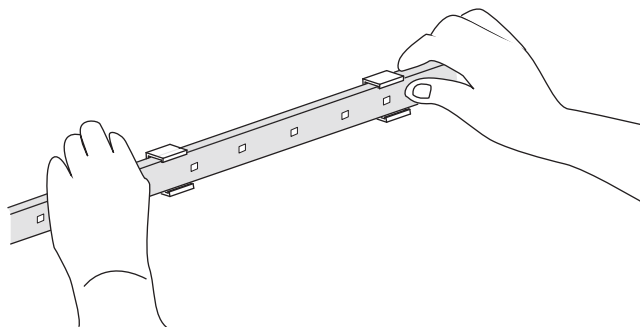

Step 7: Connect to Power

Connect the other end of the PS-Link Connector to the power supply and plug the power supply into the wall outlet.

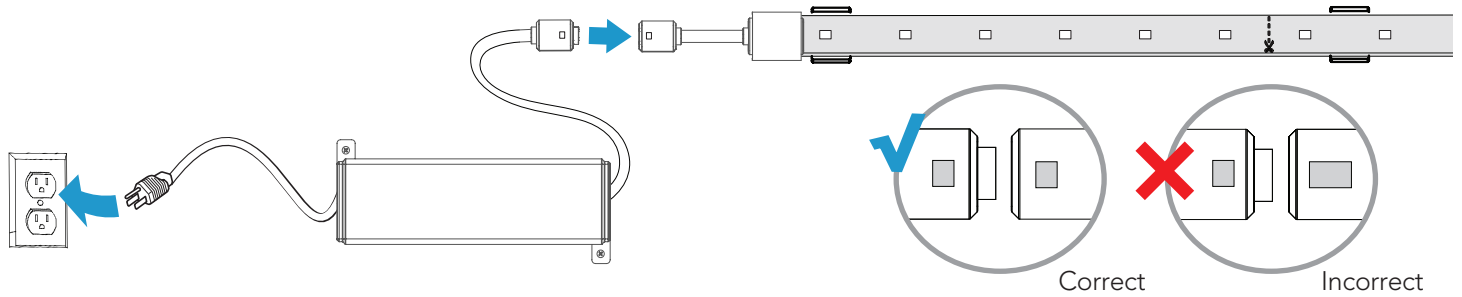

IMPORTANT: There is only one way to connect the PS-Link Connector to the power supply. Make certain the icons match before connecting.

TROUBLESHOOTING

Most of the problems you may encounter will be caused by improper assembly. If you have any questions or need additional parts, please contact our customer service.

| ISSUE | Go Through the Solutions: |
|--|--|
| None of the LED strip is lit | <ul style="list-style-type: none"> • Make sure power supply is plugged in and the AC power outlet is getting power. • Check connection from PS-Link Connector to Power Supply. • Check the connection on the PS-Link Connector to the LED strip. Pull the strip. If it comes out of the connector, you will need a new connector. |
| Only part of the LED strip is lit | <ul style="list-style-type: none"> • Check all connectors attached to the part of the strip that is not lit. Pull the LED strip. If it comes out of the connector, you will need a new connector. |
| LED strip is flashing On and OFF | <ul style="list-style-type: none"> • Make sure you are using the Power Supply shipped with the Starter Kit. If you bought another kit or additional LED strip, check the Power Supply specifications to make sure it supports the additional length. |
| LED strip not cut exactly on cut line | <ul style="list-style-type: none"> • Depending on how you cut the strip, you may still be able to save that section. The cutting tolerance is about +/- 3 mm (+/- 1/8 inch) on either side of the cut line. Cutting in a straight line is crucial and the two wires inside the strip must be pushed to the very end inside the connector to make contact with the pins. • Go to the cut line before the cut line you incorrectly cut and make the section shorter. You may be able to adjust your layout by moving the sections around. • Contact customer service to purchase additional LED strip or Straight Connectors. |
| Connectors pushed together before installation | <ul style="list-style-type: none"> • If you pushed the connector top into the bottom before installation or if the LED strip was not pushed completely to the end of the connector and did not secure the strip, you may be able to save the part. Use a flat screw driver to gently widen the sides of the top connector and push the bottom connector apart. NOTE: This may not fix the connector and you will need to use a new connector. • Contact customer service to purchase additional connectors. |